

产品规格书 Product Datasheet

型号 Model: Rb-LK-10M165.2Y01

产品类型 Lens Type: 液态定焦镜头 / Liquid FA Lens

性能参数 Spec Parameters:

焦距 Focal Length (f) /mm	16
最大像圆 Max. Image Circle /mm	Ø18.5
兼容靶面 Compatible Sensor Size	1.1"
光圈 Aperture F#	5.2
工作距离 Working Distance/mm	200
畸变 Distortion /%	≤3
接口 Mount	C
法兰距 Flange Back Length	17.52
净重 Net Weight/g	118
连接头 Connector	Aviation Connector P4
对角线视角 (Diagonal Angle of View) /°	60°
工作温度 Operating Temperature	-10°C~+50°C
存储温度 Storage Temperature	-20°C~+60°C

外形尺寸 Mechanical Size

Unit: mm

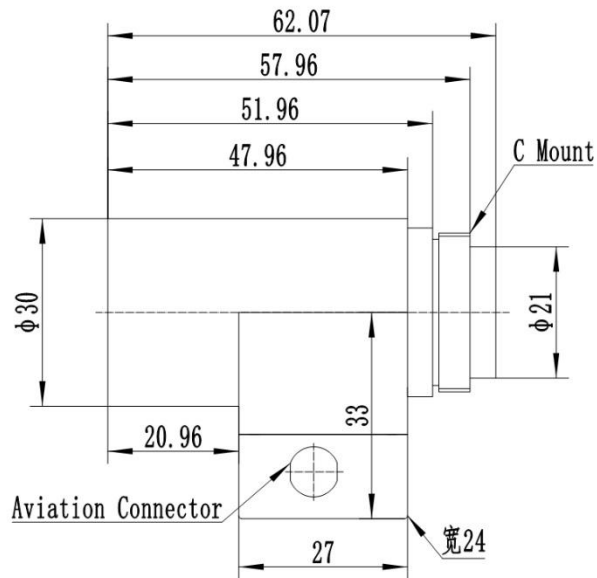

MTF Diagram

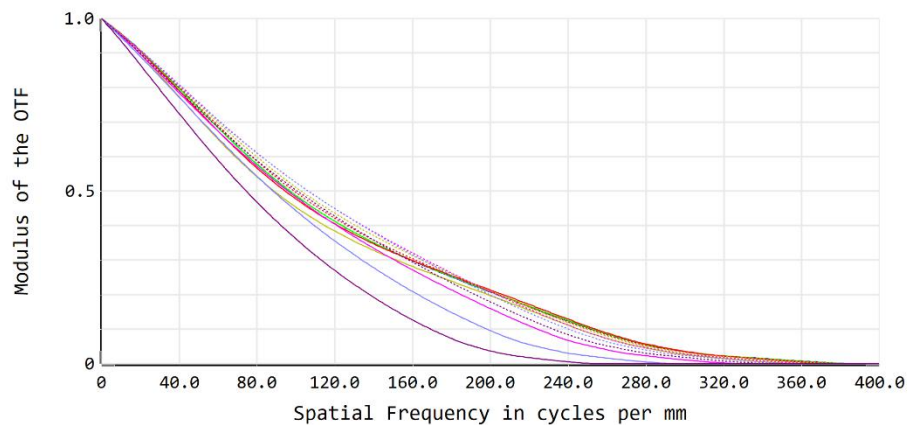

<input checked="" type="checkbox"/> 0.00 (deg)-Tangential	<input checked="" type="checkbox"/> 0.00 (deg)-Sagittal	<input checked="" type="checkbox"/> 3.02 (deg)-Tangential	<input checked="" type="checkbox"/> 3.02 (deg)-Sagittal	<input checked="" type="checkbox"/> 9.06 (deg)-Tangential	<input checked="" type="checkbox"/> 9.06 (deg)-Sagittal
<input checked="" type="checkbox"/> 15.50 (deg)-Tangential	<input checked="" type="checkbox"/> 15.50 (deg)-Sagittal	<input checked="" type="checkbox"/> 21.92 (deg)-Tangential	<input checked="" type="checkbox"/> 21.92 (deg)-Sagittal	<input checked="" type="checkbox"/> 26.85 (deg)-Tangential	<input checked="" type="checkbox"/> 26.85 (deg)-Sagittal
<input checked="" type="checkbox"/> 26.85 (deg)-Tangential	<input checked="" type="checkbox"/> 26.85 (deg)-Sagittal	<input checked="" type="checkbox"/> 31.00 (deg)-Tangential	<input checked="" type="checkbox"/> 31.00 (deg)-Sagittal	<input checked="" type="checkbox"/> 31.00 (deg)-Tangential	<input checked="" type="checkbox"/> 31.00 (deg)-Sagittal

Polychromatic Diffraction MTF	
2022/11/22 Data for 0.4860 to 0.6560 μm . Surface: Image	Zemax Zemax OpticStudio 19.4
Legend items refer to Field positions	LK-10M165.2Y01.ZMX Configuration 1 of 1