

产品规格书 Product Datasheet

型号 Model: Rb- LB-G783.2Y01

产品类型 Lens Type: 液态板机镜头 / Liquid S-mount lens

性能参数 Spec Parameters:

焦距 Focal Length (f) /mm	8
最大像圆 Max. Image Circle /mm	Ø8
光圈 Aperture F#	3.2
工作距离 Working Distance/mm	100-∞
畸变 Distortion /%	9
接口 Mount	M12
对角线视角 (Diagonal Angle of View) /°	58.2
净重 Net Weight/g	19.6
工作温度 Operating Temperature	-10°C~+50°C
存储温度 Storage Temperature	-20°C~+60°C

外形尺寸 Mechanical Size

Unit: mm

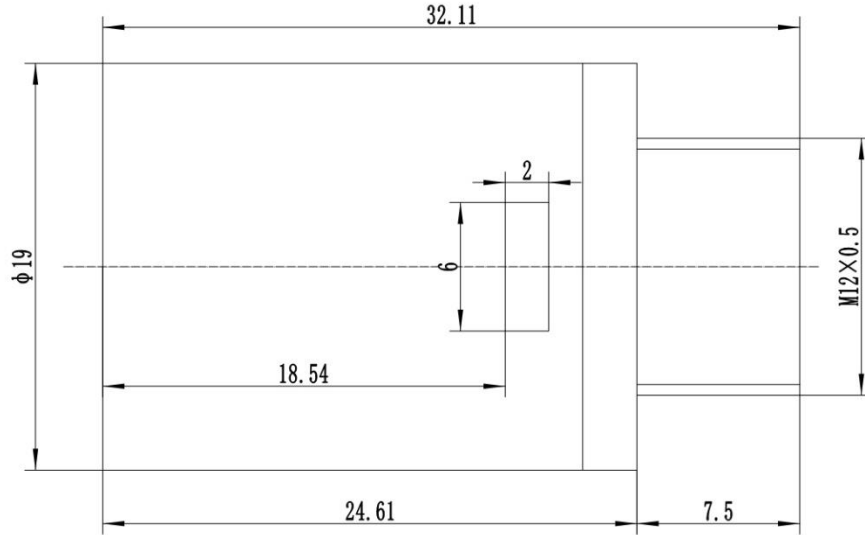

MTF Diagram

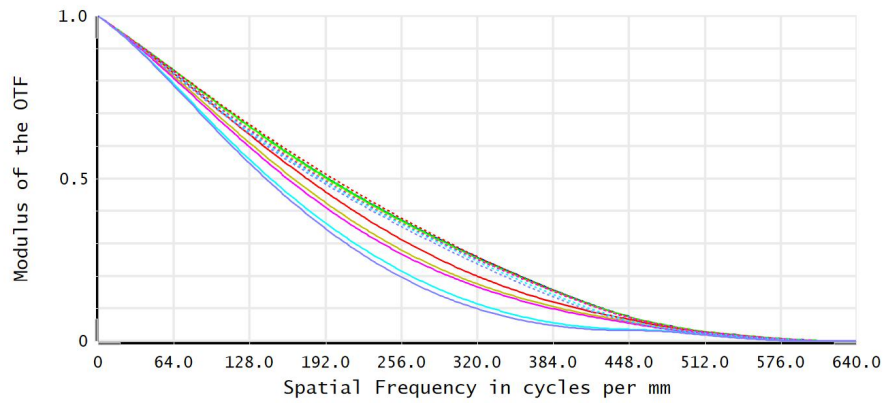

0.00 (deg)-Tangential	0.00 (deg)-Sagittal	2.92 (deg)-Tangential	2.92 (deg)-Sagittal
14.55 (deg)-Tangential	14.55 (deg)-Sagittal	18.80 (deg)-Tangential	18.80 (deg)-Sagittal
20.57 (deg)-Tangential	20.57 (deg)-Sagittal	28.00 (deg)-Tangential	28.00 (deg)-Sagittal
29.10 (deg)-Tangential	29.10 (deg)-Sagittal		

Polychromatic Diffraction MTF	
2023-7-26 Data for 0.4860 to 0.6560 μm . Surface: Image	Zemax Zemax OpticStudio 17.5
Legend items refer to Field positions	LB-G783.2Y01.ZMX Configuration 1 of 1