

产品规格书 Product Datasheet

型号 Model: Rb-LB-G7506.6Y03

产品类型 Lens Type: 液态板机镜头 / Liquid S--mount lens

性能参数 Spec Parameters:

焦距 Focal Length (f) /mm	50
最大像圆 Max. Image Circle /mm	Ø6.7
光圈 Aperture F#	6.6
畸变 Distortion /%	0.5
接口 Mount	M12
净重 Net Weight/g	TBD
工作温度 Operating Temperature	-10°C~+50°C
存储温度 Storage Temperature	-20°C~+60°C

外形尺寸 Mechanical Size

Unit: mm

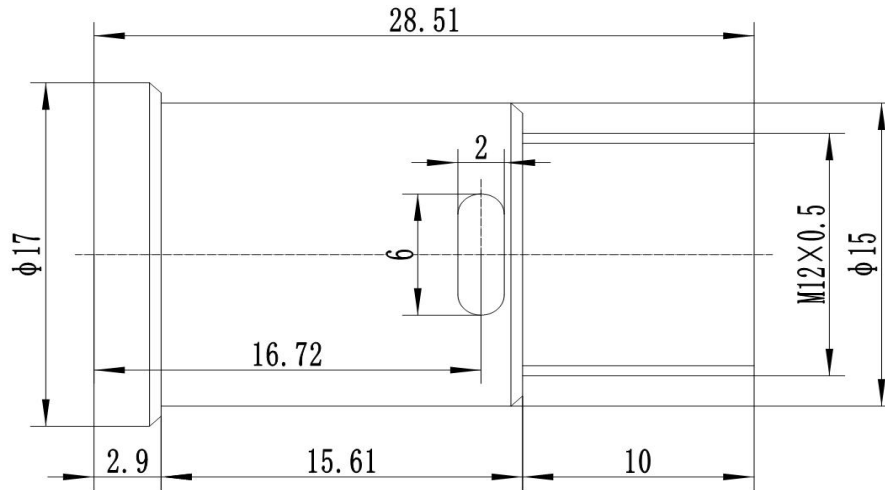

MTF Diagram

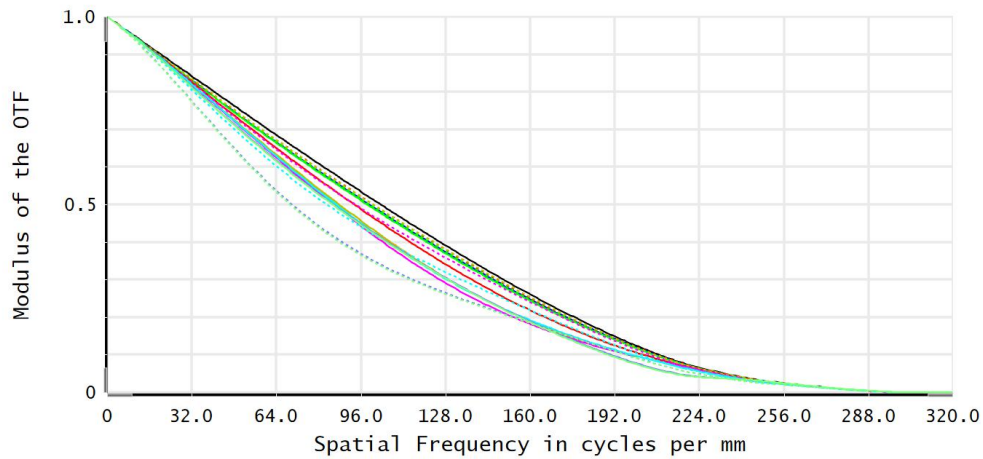

<input checked="" type="checkbox"/> Diff. Limit-Tangential	<input checked="" type="checkbox"/> Diff. Limit-Sagittal	<input checked="" type="checkbox"/> 0.0000 (deg)-Tangential	<input checked="" type="checkbox"/> 0.0000 (deg)-Sagittal	<input checked="" type="checkbox"/> 0.3890 (deg)-Tangential	<input checked="" type="checkbox"/> 0.3890 (deg)-Sagittal
<input checked="" type="checkbox"/> 1.1670 (deg)-Tangential	<input checked="" type="checkbox"/> 1.1670 (deg)-Sagittal	<input checked="" type="checkbox"/> 1.9450 (deg)-Tangential	<input checked="" type="checkbox"/> 1.9450 (deg)-Sagittal	<input checked="" type="checkbox"/> 2.7502 (deg)-Tangential	<input checked="" type="checkbox"/> 2.7502 (deg)-Sagittal
<input checked="" type="checkbox"/> 3.3065 (deg)-Tangential	<input checked="" type="checkbox"/> 3.3065 (deg)-Sagittal	<input checked="" type="checkbox"/> 3.8600 (deg)-Tangential	<input checked="" type="checkbox"/> 3.8600 (deg)-Sagittal	<input checked="" type="checkbox"/> 3.8900 (deg)-Tangential	<input checked="" type="checkbox"/> 3.8900 (deg)-Sagittal

Polychromatic Diffraction MTF	
2024-5-15 Data for 0.4861 to 0.6563 μm . Surface: Image	Zemax Zemax OpticStudio 17.5
Legend items refer to Field positions	LB-G7506.6Y03.ZMX Configuration 1 of 1